



ACTIVITIES & KNOW-HOW



Out of a simple sheet of metal cut, folded, bent, shaped, pressed and welded, GUILLET SERV produces the widest range of parts – from the basic wedge to the most intricate shapes and complex assemblies – for the following industries:

- Aerospace
- Military
- Optronics

Sheet-metal working and high-precision metalworking

Equipped with CAD-CAM and ERP software, we analyze the data provided by our customers, design the tools and dies, define the technical specifications and operational modes for efficient production planning and control, thus ensuring our manufacturing process maintains the high standards of organization, quality and traceability required by our activities.

The use of the FaroArm guarantees the dimensional conformity of even the largest products.

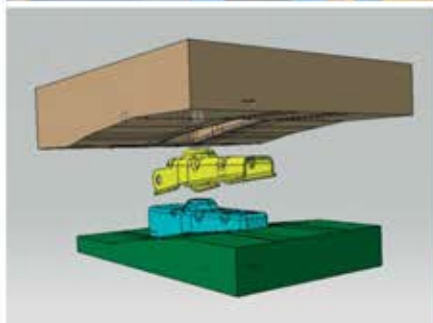

Zone Industrielle Antonypôle • Rue Luigi Galvani • 92167 Antony Cedex
Téléphone : 33(0)1 56 45 10 00 • Télécopie : 33(0)1 42 37 79 19
E-mail : contact@guillet-tech.com

www.guillet-tech.com